

Stephen Kinsey & Tho^s Armstrong

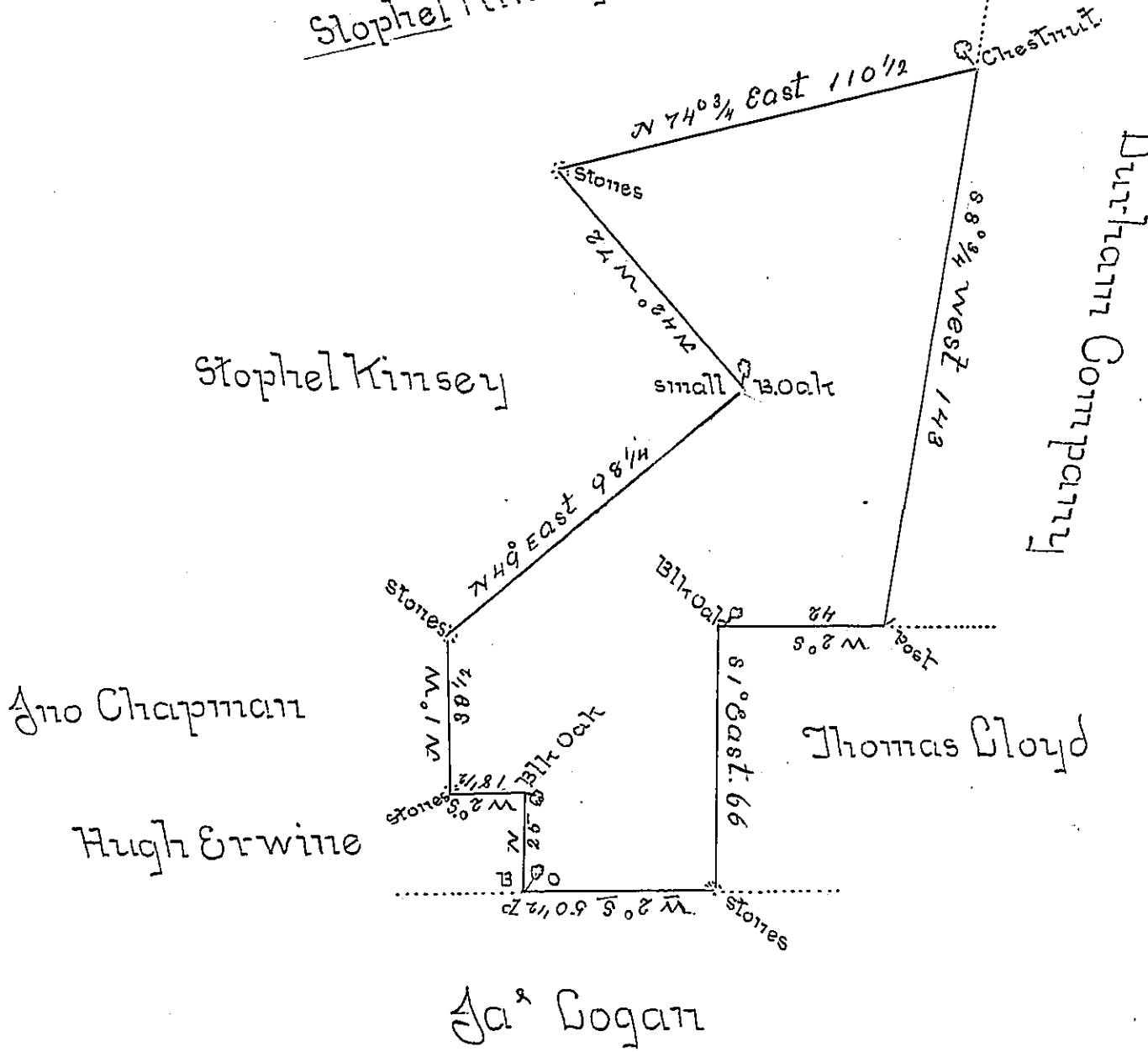

A Tract of Eighty Three Acres and 32 perches of Land
 & Meadow situate in the Township of Lower Saucon &
 Springfield in the County of Bucks. Surveyed to Hugh
 Erwine the 24 of the Month called August 1752 pur-
 suant to a Warrant of the 16 Day of December 1749 (OS)

by John Watson Jun^r

IN TESTIMONY that the above is a copy of the original remaining on file in the
 Department of Internal Affairs of Pennsylvania, made con-
 formably to an Act of Assembly approved the 16th day of
 February, 1833, I have hereunto set my Hand and caused
 the Seal of said Department to be affixed at Harrisburg, this

Sixth day of January 1897

James W. Lewis
 Secretary of Internal Affairs.